



4. Indicate the type of license applying for: (choose only one)

- |                                                                                                                    |                                                                          |                                                                  |
|--------------------------------------------------------------------------------------------------------------------|--------------------------------------------------------------------------|------------------------------------------------------------------|
| <input type="checkbox"/> Restaurant<br>(Class I, II, III, IV)                                                      | <input type="checkbox"/> Class A Restaurant/Lounge<br>(Class XI)         | <input type="checkbox"/> Class A Lounge<br>(Class X)             |
| <input type="checkbox"/> Hotel<br>(Class I, II, III, IV)                                                           | <input type="checkbox"/> Hotel – Food Optional<br>(Class I-A)            | <input checked="" type="checkbox"/> Bed & Breakfast<br>(Class V) |
| <input type="checkbox"/> Golf Course (included optional licenses, please check if apply)<br>(Class I, II, III, IV) | <input type="checkbox"/> Auxiliary                                       | <input type="checkbox"/> Mobile Cart                             |
| <input type="checkbox"/> Tavern<br>(Class IV)                                                                      | <input type="checkbox"/> Other: _____                                    |                                                                  |
| <input type="checkbox"/> Qualified Caterer                                                                         | <input type="checkbox"/> Self-Sponsored Events (Qualified Caterers Only) |                                                                  |

Refer to Section V for the License Fee Schedule on page 9

5. Business records are located at the following address:

213 Main Street, Freeport, Maine 04032

---

6. Is the licensee/applicant(s) citizens of the United States?  Yes  No
7. Is the licensee/applicant(s) a resident of the State of Maine?  Yes  No

**NOTE: Applicants that are not citizens of the United States are required to file for the license as a business entity.**

8. Is licensee/applicant(s) a business entity like a corporation or limited liability company?

Yes  No If Yes, complete Section VII at the end of this application

9. For a licensee/applicant who is a business entity as noted in Section I, does any officer, director, member, manager, shareholder or partner have in any way an interest, directly or indirectly, in their capacity in any other business entity which is a holder of a wholesaler license granted by the State of Maine?

Yes  No

Not applicable – licensee/applicant(s) is a sole proprietor

10. Is the licensee or applicant for a license receiving, directly or indirectly, any money, credit, thing of value, endorsement of commercial paper, guarantee of credit or financial assistance of any sort from any person or entity within or without the State, if the person or entity is engaged, directly or indirectly, in the manufacture, distribution, wholesale sale, storage or transportation of liquor.

Yes  No

If yes, please provide details: \_\_\_\_\_  
 \_\_\_\_\_

11. Do you own or have any interest in any another Maine Liquor License?  Yes  No

If yes, please list license number, business name, and complete physical location address: (attach additional pages as needed using the same format)

Name of Business	License Number	Complete Physical Address

12. List name, date of birth, place of birth for all applicants including any manager(s) employed by the licensee/applicant. Provide maiden name, if married. (attach additional pages as needed using the same format)

Full Name	DOB	Place of Birth
Stephanie Fitch (nee Acford)	07/16/1961	England
Keith Huss	12/29/1958	Pennsylvania
Matthew Fitch	07/09/1991	England

Residence address on all the above for previous 5 years

Name Stephanie Fitch	Address: 225 Elm Street, Concord, MA 01742
Name Keith Huss	Address: 225 Elm Street, Concord, MA 01742
Name Matthew Fitch	Address: 23 Old Mamaroneck Road, Apt. 2M, White Plains, NY 10605
Name	Address:

13. Will any law enforcement officer directly benefit financially from this license, if issued?

Yes  No

If Yes, provide name of law enforcement officer and department where employed:

\_\_\_\_\_

14. Has the licensee/applicant(s) ever been convicted of any violation of the liquor laws in Maine or any State of the United States?  Yes  No

If Yes, please provide the following information and attach additional pages as needed using the same format.

Name: \_\_\_\_\_ Date of Conviction: \_\_\_\_\_

Offense: \_\_\_\_\_ Location: \_\_\_\_\_

Disposition: \_\_\_\_\_

15. Has the licensee/applicant(s) ever been convicted of any violation of any law, other than minor traffic violations, in Maine or any State of the United States?  Yes  No

If Yes, please provide the following information and attach additional pages as needed using the same format.

Name: \_\_\_\_\_ Date of Conviction: \_\_\_\_\_

Offense: \_\_\_\_\_ Location: \_\_\_\_\_

Disposition: \_\_\_\_\_

16. Has the licensee/applicant(s) formerly held a Maine liquor license?  Yes  No

17. Does the licensee/applicant(s) own the premises?  Yes  No

If No, please provide the name and address of the owner:

\_\_\_\_\_

18. If you are applying for a liquor license for a Hotel or Bed & Breakfast, please provide the number of guest rooms available: 7.00

19. Please describe in detail the area(s) within the premises to be licensed. This description is in addition to the diagram in Section VI. (Use additional pages as needed)

Games Room, Dining Room

---

---

---

20. What is the distance from the premises to the **nearest** school, school dormitory, church, chapel or parish house, measured from the main entrance of the premises to the main entrance of the school, school dormitory, church, chapel or parish house by the ordinary course of travel?

Name: Freeport Middle School

Distance: 0.50

**Section II: Signature of Applicant(s)**

By signing this application, the licensee/applicant understands that false statements made on this application are punishable by law. Knowingly supplying false information on this application is a Class D Offense under Maine's Criminal Code, punishable by confinement of up to one year, or by monetary fine of up to \$2,000 or by both.

Please sign and date in blue ink.

Dated: 01-FEB-24

Stephanie Fitch

Signature of Duly Authorized Person

Keith Huss

Signature of Duly Authorized Person

STEPHANIE FITCH

Printed Name Duly Authorized Person

KEITH HUSS

Printed Name of Duly Authorized Person

**Section III: For use by Municipal Officers and County Commissioners only**

The undersigned hereby certifies that we have complied with the process outlined in 28-A M.R.S. §653 and approve this on-premises liquor license application.

Dated: \_\_\_\_\_

Who is approving this application?  Municipal Officers of \_\_\_\_\_

County Commissioners of \_\_\_\_\_ County

- Please Note:** The Municipal Officers or County Commissioners must confirm that the records of Local Option Votes have been verified that allows this type of establishment to be licensed by the Bureau for the type of alcohol to be sold for the appropriate days of the week. Please check this box to indicate this verification was completed.

Signature of Officials	Printed Name and Title

**This Application will Expire 60 Days from the date of Municipal or County Approval unless submitted to the Bureau**

Included below is the section of Maine’s liquor laws regarding the approval process by the municipalities or the county commissioners. This is provided as a courtesy only and may not reflect the law in effect at the time of application. Please see <http://www.mainelegislature.org/legis/statutes/28-A/title28-Asec653.html>

§653. Hearings; bureau review; appeal

**1. Hearings.** The municipal officers or, in the case of unincorporated places, the county commissioners of the county in which the unincorporated place is located, may hold a public hearing for the consideration of applications for new on-premises licenses and applications for transfer of location of existing on-premises licenses. The municipal officers or county commissioners may hold a public hearing for the consideration of requests for renewal of licenses, except that when an applicant has held a license for the prior 5 years and a complaint has not been filed against the applicant within that time, the applicant may request a waiver of the hearing.

A. The bureau shall prepare and supply application forms.

**Section VI Premises Floor Plan**

In an effort to clearly define your license premise and the areas that consumption and storage of liquor authorized by your license type is allowed, the Bureau requires all applications to include a diagram of the premise to be licensed.

Diagrams should be submitted on this form and should be as accurate as possible. Be sure to label the following areas: entrances, office area, coolers, storage areas, display cases, shelves, restroom, point of sale area, area for on-premise consumption, dining rooms, event/function rooms, lounges, outside area/decks or any other areas on the premise that you are requesting approval. Attached an additional page as needed to fully describe the premise.

PLEASE SEE ATTACHED

The Kendall Inn is a 7-room bed and breakfast located in Freeport, Maine.

Bathrooms are located on floors 2 and 3 where each bedroom has its own private facility.

The primary purpose of this application is to allow us to establish an "honor" bar for our guests that will allow them to purchase wine or beer in the evenings.

We also plan to offer mimosas at breakfast. The sole reason for applying for a full liquor license is to allow us to also offer Bloody Mary's at breakfast (between the hours of 8am and 10am only). There are no plans to offer hard liquor outside of this one use-case.

In all instances, the consumption of alcohol will be fully supervised and only available to registered guests staying at the Inn.

Thank-you for your consideration.

Stephanie & Keith



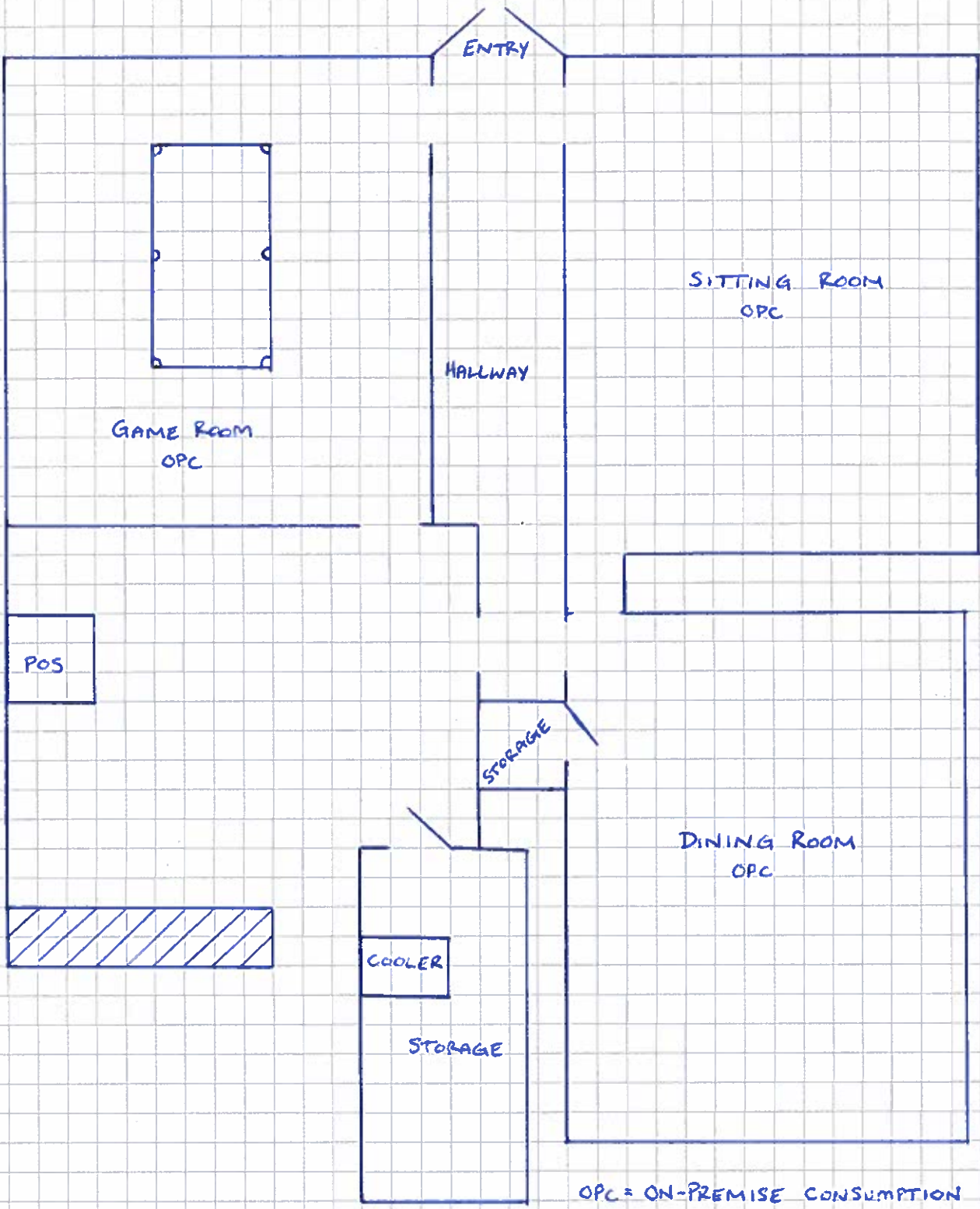

**Section VII: Required Additional Information for a Licensee/Applicant for an On-Premises Liquor License Who are Legal Business Entities**

Questions 1 to 4 of this part of the application must match information in Section I of the application above and match the information on file with the Maine Secretary of State’s office. If you have questions regarding your legal entity name or DBA, please call the Secretary of State’s office at (207) 624-7752.

*All Questions Must Be Answered Completely. Please print legibly.*

1. Exact legal name: Kendall Tavern Inn, LLC
2. Doing Business As, if any: The Kendall Inn
3. Date of filing with Secretary of State: 05/18/2023 State in which you are formed: Maine
4. If not a Maine business entity, date on which you were authorized to transact business in the State of Maine: N/A
5. List the name and addresses for previous 5 years, birth dates, titles of officers, directors, managers, members or partners and the percentage ownership any person listed: (attached additional pages as needed)

Name	Address (5 Years)	Date of Birth	Title	Percentage of Ownership
Stephanie Fitch	225 Elm Street, Concord, MA	07/16/1961	Owner	50.0000
Keith Huss	225 Elm Street, Concord, MA	12/29/1958	Owner	50.0000

(Ownership in non-publicly traded companies must add up to 100%.)