



LOCATION MAP N.T.S.

LEGEND

○	IRON PIPE OR ROD FOUND	---	PROPERTY BOUNDARY
□	MONUMENT FOUND	—X—X—	FENCE
⊙	UTILITY POLE	—OHW—	OVERHEAD WIRES
⊙	LIGHT POLE	—OWH—	OVERHEAD WIRES
⊙	ELECTRIC BOX	—UG—	UNDERGROUND ELECTRIC
⊙	SIGN	—UGC—	UNDERGROUND COMM.
⊙	MAILBOX	—100—	1' CONTOUR
⊙	WATER SPICKET	—IPF/IRF—	IRON PIPE OR ROD FOUND
⊙	DECIDUOUS TREE	—N/F—	NOW OR FORMERLY
⊙	CONIFEROUS TREE	—000/000—	DEED BOOK / PAGE
		⊙	CAMP SITE TREE w/SIGN

- PLAN REFERENCES**
- "BOUNDARY SURVEY AT 93 DESERT ROAD, FREEPORT, MAINE FOR DWIGHT AND DEBORAH PENSIERO" DATED JANUARY 5, 2007 BY OWEN HASKELL, INC.
 - "SKETCH OF LAND IN FREEPORT AND POWNAL, MAINE FOR ELAINE R. POLAKIEWICH" DATED JANUARY 25, 1990 BY OWEN HASKELL, INC.
 - "FINAL SUBDIVISION PLAN (SH. 1 OF 2 & SH. 2 OF 2) FOR TIMBERLAND DEVELOPMENT CO. WEBSTER CROSSING" DATED OCTOBER 29, 2002 BY COFFIN ENGINEERING & SURVEYING, INC., AND REVISED JANUARY 3, 2003 RECORDED IN THE CUMBERLAND COUNTY REGISTRY OF DEEDS IN PLAN BOOK 2023, PAGES 203 & 204.
 - "PLAN OF LAND IN FREEPORT, MAINE FOR ELIZABETH GOLDRUP" DATED NOVEMBER 24, 1981 AND REVISED NOVEMBER 13, 1989 BY OWEN HASKELL.

- GENERAL NOTES**
- OWNER OF RECORD: HEESTAND FAMILY HOLDING LLC
116 DUNE DRIVE, FREEPORT, MAINE
TAX MAP 22 LOT 8
C.C.R.D. BOOK 35335 PAGE 17
 - BEARINGS ARE BASED ON STATE PLANE COORDINATE SYSTEM, MAINE WEST ZONE, NAD 83.
 - ELEVATIONS AND GROUND TOPOGRAPHIC CONTOURS WERE DERIVED FROM GPS OBSERVATIONS AND ARE BASED ON NAVD83. SITE BENCHMARK IS A PK NAIL IN POLE NO. 72 ELEVATION: 128.20'.
 - A PORTION OF THE GROUND CONTOURS AS SHOWN AND LABELED WERE DERIVED FROM LIDAR DATA AVAILABLE AT THE NOAA DATA ACCESS VIEWER. NO FIELD VERIFICATION WAS COMPLETED BY THIS FIRM.
 - SURVEY WAS PERFORMED UNDER SNOW AND ICE COVER CONDITIONS.

UTILITY NOTE

THE UNDERGROUND UTILITIES SHOWN HAVE BEEN LOCATED FROM FIELD SURVEY INFORMATION AND EXISTING DRAWINGS. THE SURVEYOR MAKES NO GUARANTEES THAT THE UNDERGROUND UTILITIES SHOWN COMPRISE ALL SUCH UTILITIES IN THE AREA, EITHER IN SERVICE OR ABANDONED. THE SURVEYOR FURTHER DOES NOT WARRANT THAT THE UNDERGROUND UTILITIES SHOWN ARE IN THE EXACT LOCATION INDICATED ALTHOUGH HE DOES CERTIFY THAT THEY ARE LOCATED AS ACCURATELY AS POSSIBLE FROM INFORMATION AVAILABLE. THE SURVEY HAS NOT PHYSICALLY LOCATED THE UNDERGROUND UTILITIES. CALL 1-888-DIGSAFE AT LEAST THREE BUSINESS DAYS BEFORE PERFORMING ANY CONSTRUCTION.

CERTIFICATE

OWEN HASKELL, INC. HEREBY CERTIFIES THAT THIS PLAN IS BASED ON, AND THE RESULT OF, AN ON THE GROUND FIELD SURVEY AND THAT TO THE BEST OF OUR KNOWLEDGE, INFORMATION AND BELIEF, IT CONFORMS TO THE BOARD OF LICENSURE FOR PROFESSIONAL LAND SURVEYORS CURRENT STANDARDS OF PRACTICE.

DAVID R. JACQUES, PLS #2132

DATE

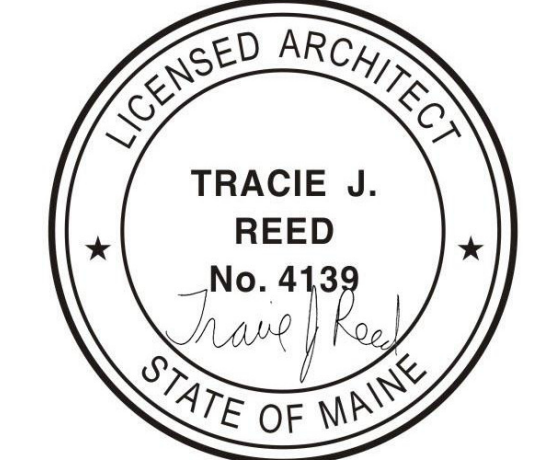
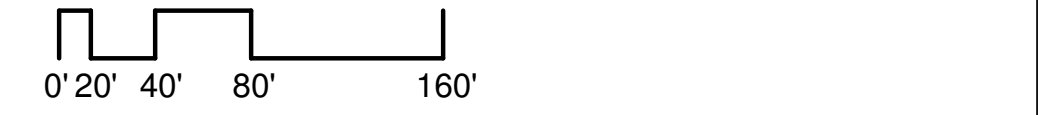

LOCATION
Tax map 22, Lot 8
95 Desert Road
Freeport, ME 04032



DEXTRIOUS CREATIVE

217 COMMERCIAL STREET, SUITE 402
PORTLAND, ME 04101
TRACIE REED, ARCHITECT
NCARB, AIA, LEED AP BD-C
traciereed@dextrouscreative.com
207.409.0459 (cell)



CLIENT
Doug & Mela Heestand
Desert of Maine
95 Desert Road
Freeport, ME 04032
doug@desertofmaine.com

STRUCTURAL ENGINEER
Aaron C. Jones, P.E., LEED
Structural Integrity Consulting Engineers, Inc.
46 Forest Avenue
Portland, ME 04101
aaron@structuralinteg.com

GENERAL CONTRACTOR
Chris Toriello
Toriello Construction, Inc.
79 Town Farm Road
North Yarmouth, ME 04097
(207) 776-0301
ctoriello@maine.rr.com

OVERALL SITE PLAN	
Project number	22-42_Desert of Maine
Date	October 10, 2022
Drawn by	LT, TO & TJR
Project Status	BUILDING PERMIT
C20-1	
Scale	1" = 80'-0"

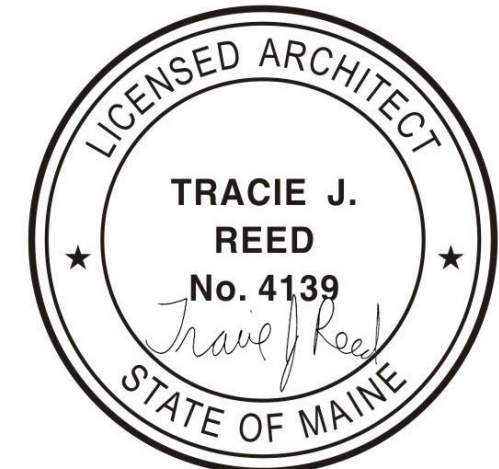

LOCATION
 Tax map 22, Lot 8
 95 Desert Road
 Freeport, ME 04032



**DEXTRIOUS
 CREATIVE**

217 COMMERCIAL STREET, SUITE 402
 PORTLAND, ME 04101
 TRACIE REED, ARCHITECT
 NCARB, AIA, LEED AP BD-C
 traciereed@dextrouscreative.com
 207.409.0459 (cell)



CLIENT
 Doug & Mela Heestand
 Desert of Maine
 95 Desert Road
 Freeport, ME 04032
 doug@desertofmaine.com

STRUCTURAL ENGINEER
 Aaron C. Jones, P.E., LEED
 Structural Integrity Consulting Engineers, Inc.
 46 Forest Avenue
 Portland, ME 04101
 aaron@structuralinteg.com

GENERAL CONTRACTOR
 Chris Toriello
 Toriello Construction, Inc.
 79 Town Farm Road
 North Yarmouth, ME 04097
 (207) 776-0301
 ctoriello@maine.rr.com

EXISTING SITE PLAN - ENLARGED	
Project number	22-42_Desert of Maine
Date	October 10, 2022
Drawn by	LT, TO & TJR
Project Status	BUILDING PERMIT
C10-2	
Scale	1" = 30'-0"

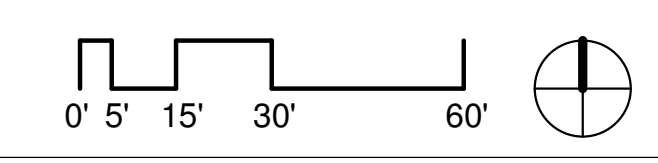

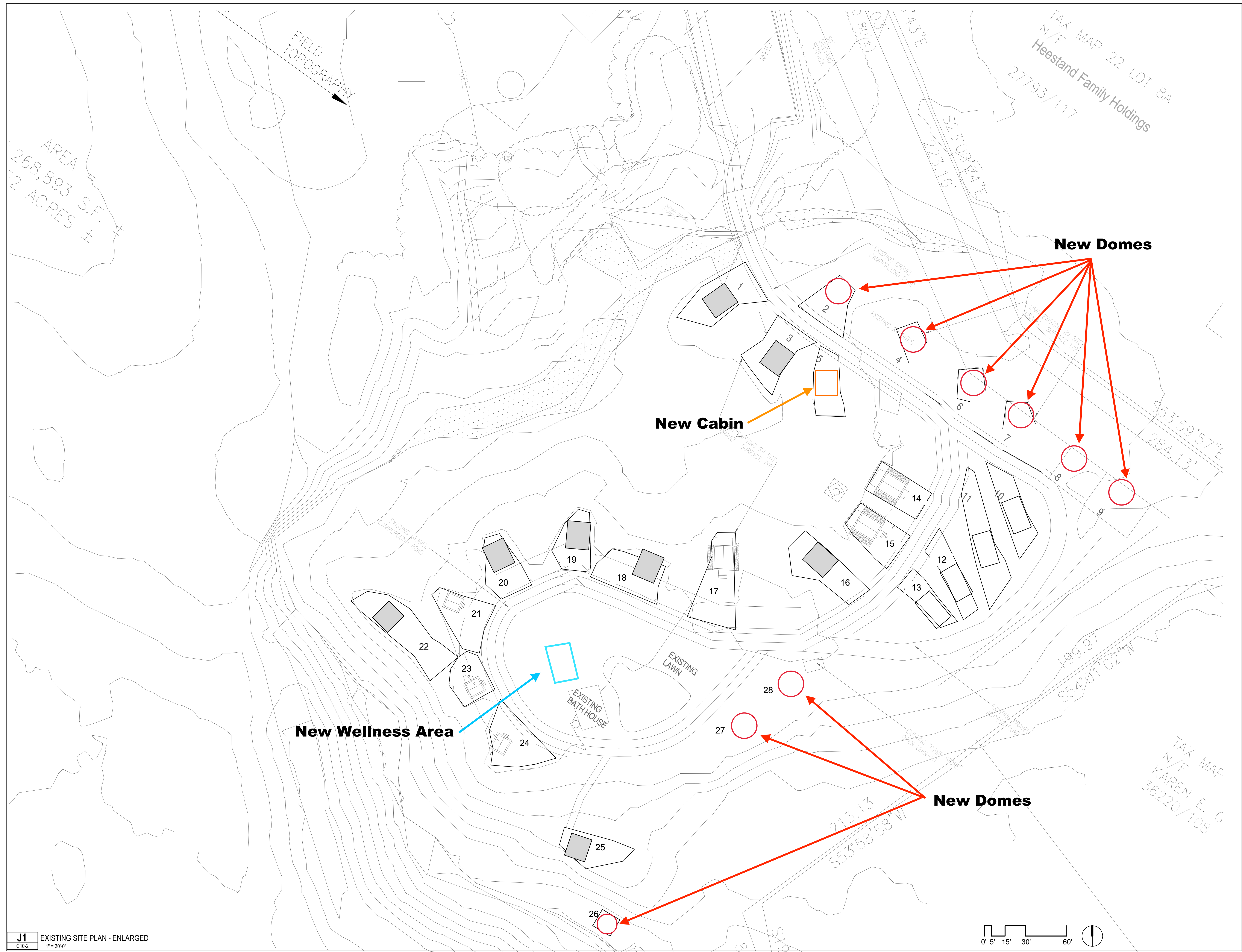

J1 EXISTING SITE PLAN - ENLARGED
 C10-2 1" = 30'-0"

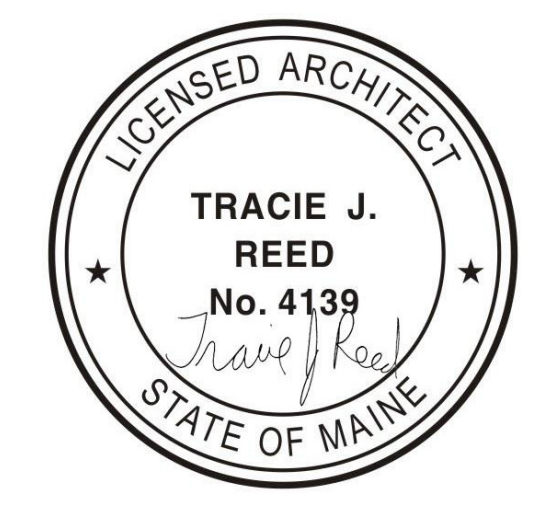
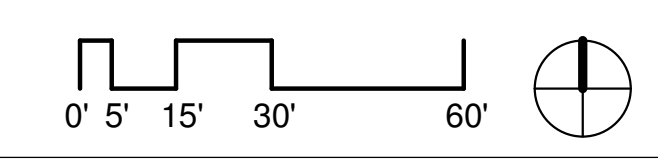

LOCATION
 Tax map 22, Lot 8
 95 Desert Road
 Freeport, ME 04032



**DEXTRIOUS
 CREATIVE**

217 COMMERCIAL STREET, SUITE 402
 PORTLAND, ME 04101
 TRACIE REED, ARCHITECT
 NCARB, AIA, LEED AP BD-C
 traciereed@dextrouscreative.com
 207.409.0459 (cell)



CLIENT
 Doug & Mela Heestand
 Desert of Maine
 95 Desert Road
 Freeport, ME 04032
 doug@desertofmaine.com

STRUCTURAL ENGINEER
 Aaron C. Jones, P.E., LEED
 Structural Integrity Consulting Engineers, Inc.
 46 Forest Avenue
 Portland, ME 04101
 aaron@structuralinteg.com

GENERAL CONTRACTOR
 Chris Toriello
 Toriello Construction, Inc.
 79 Town Farm Road
 North Yarmouth, ME 04097
 (207) 776-0301
 ctoriello@maine.rr.com

PROPOSED SITE PLAN - ENLARGED	
Project number	22-42_Desert of Maine
Date	October 10, 2022
Drawn by	LT, TO & TJR
Project Status	BUILDING PERMIT
C10-2	
Scale	1" = 30'-0"